



ENGLISH
DEUTSCHE
ESPAÑOL
FRANÇAIS
GAELIGE
ITALIANO
POLSKIE
PORTUGUÊS
SUOMALAINEN

QUICK START GUIDE

CONTENTS

Product Diagrams	2
Important Safety Information	3
Installation	4-5
Removal	6-7
Extensions & Safe Working Loads	8-10
Troubleshooting	11
Online PDF Files	12

**COMPREHENSIVE USER MANUAL
AVAILABLE ONLINE AT UNI-PROP.COM**



TEMPORARY SUPPORT

Models: Mini, Midi & Maxi

- 01 top plate
- 02 inner tube
- 03 safety stop (Maxi only)
- 04 threaded sleeve
- 05 threaded slot
- 06 top pin & wire
- 07 collar
- 08 collar handle
- 09 outer tube
- 10 ram movement slot
- 11 ram locator boss
- 12 ram access chamber
- 13 bottom pin & wire
- 14 base plate

HYDRAULIC ASSEMBLY

Model: UPHA-17-A

- 01 hose spring
- 02 pump housing
- 03 pump arm
- 04 ram stick
- 05 fill screw
- 06 hose
- 07 reservoir
- 08 ram
- 09 sealed coupling
- 10 flow valve
- 11 safety valve
- 12 grip

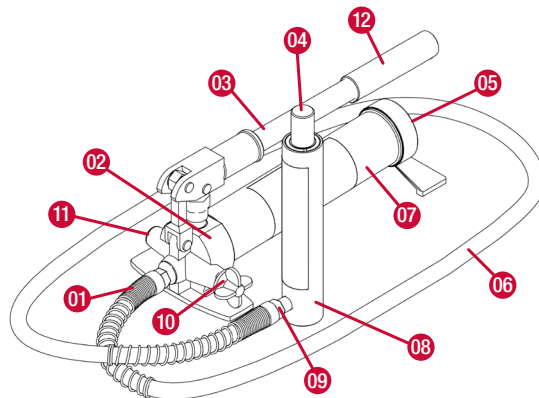

IMPORTANT SAFETY INFORMATION



Take note of safety alert symbols, which highlight potential hazards.

The above warning depicts a hazardous situation which, if not avoided, could lead to physical harm or damage to equipment or property.

PRIOR TO USE, PLEASE READ THE QUICK START GUIDE CAREFULLY AND ENSURE THAT A RISK ASSESSMENT HAS BEEN CARRIED OUT.

IN THE CONSIDERATION OF SAFE OPERATION, THE CAPACITY OF THE HYDRAULIC ASSEMBLY IS DE-RATED TO 2T (2000kg). NEVER EXCEED SAFE WORKING LOADS.

NEVER USE ANY OTHER HYDRAULIC ASSEMBLY.

IT IS RECOMMENDED THE RAM STICK EXTENSION IS LIMITED TO 100mm. IF ON MEASUREMENT THE 100mm EXTENSION WILL BE EXCEEDED, CONSIDER RAISING THE BOTTOM PIN LOCATION.

AS SOON AS THE HYDRAULIC OPERATION HAS BEEN COMPLETED, THE MECHANICAL FUNCTION MUST BE ENGAGED IMMEDIATELY TO AVOID ACCIDENT OR DAMAGE.

PLEASE NOTE: Pay special attention to all instructions written in **RED** regarding the installation and removal of Uni-Prop (pages 4-7).

Disclaimer: Uni-Prop International and its appointed resellers and distributors cannot be held responsible for any damage or injury that may occur as a result of improper use of Uni-Prop products. Make sure you have understood the correct installation and removal procedures and please note that a comprehensive User Manual is available online at uni-prop.com

UNI-PROP INSTALLATION

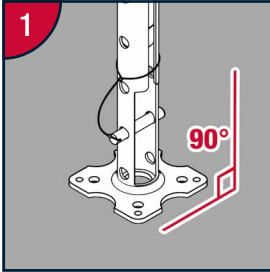

1 Place plumb on a firm flat level surface.

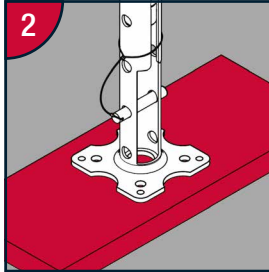

2 If necessary use a sole board to distribute load.

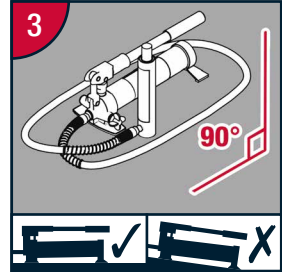

3 Place Hydraulic Assembly on level ground in horizontal position.

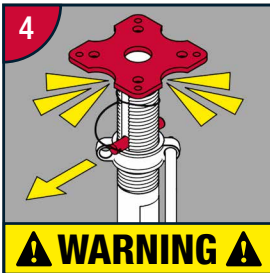

4 Remove top pin. *Inner tube fully retracts. Be aware of trap/crush injuries.*

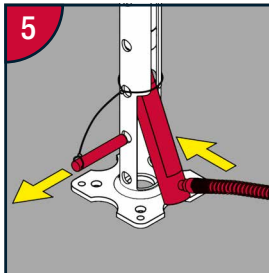

5 Remove bottom pin and insert ram into ram access chamber.

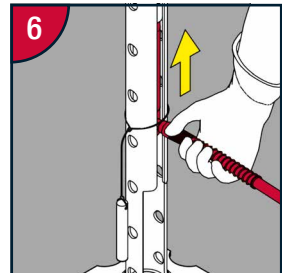

6 Lift hose to raise ram and inner tube until top plate is close to object surface.

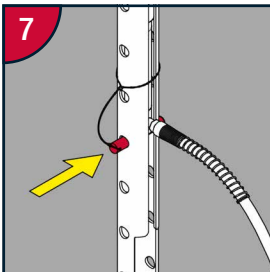

7 Insert bottom pin through first available hole directly beneath the ram.

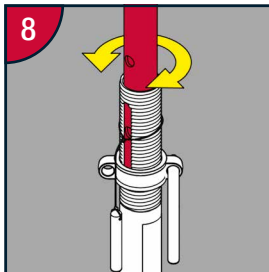

8 *Align holes of inner tube with slot in threaded collar section.*

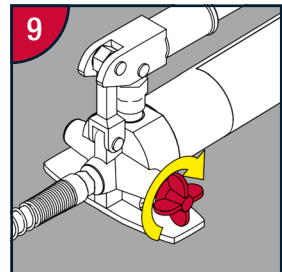

9 Check pump is horizontal and flow valve is in closed position (turn clockwise to close).

UNI-PROP INSTALLATION

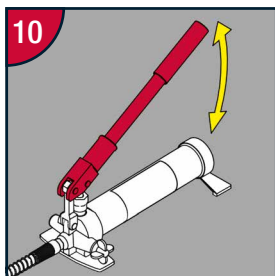

Pump the handle to raise the top plate until the required position is achieved.

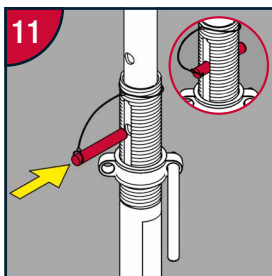

Fully insert top pin through the available hole in the threaded collar section.

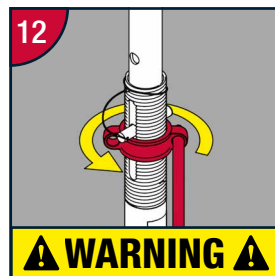

WARNING

Immediately turn collar until tight against top pin to fully secure the position.

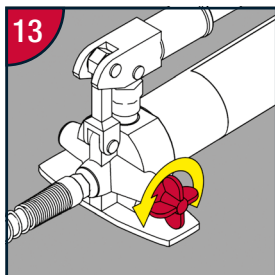

To release ram stick, open flow valve. **Never rotate more than one full turn anti-clockwise.**

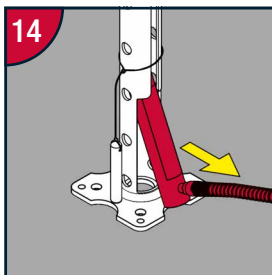

Whilst holding hose, take out bottom pin then lower hose and remove ram.

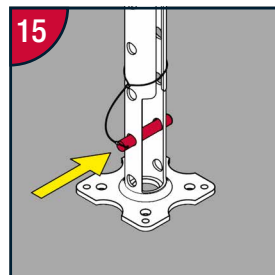

Reinsert bottom pin for storage.



WARNING

DO NOT USE EXCESSIVE FORCE WHEN PUMPING.

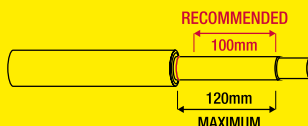

IT IS RECOMMENDED THE RAM STICK EXTENSION IS LIMITED TO 100mm. WHERE EXTENSIONS OF BETWEEN 100-120mm ARE UNAVOIDABLE, DO NOT OVER-PUMP WHEN A SIGNIFICANT CHANGE IN RESISTANCE HAS RESULTED. THIS MAY COMPROMISE THE PERFORMANCE OF THE HYDRAULIC ASSEMBLY AND INVALIDATE THE WARRANTY.

UNI-PROP REMOVAL

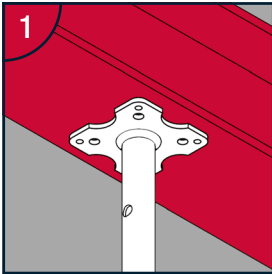

Check Uni-Prop can be removed safely.

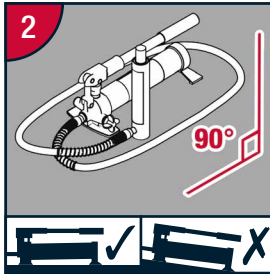

Place Hydraulic Assembly on ground in horizontal position.

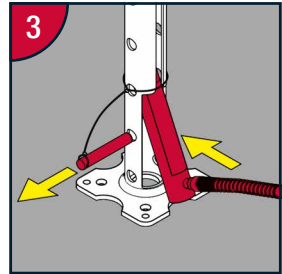

Remove bottom pin and insert ram into ram access chamber.

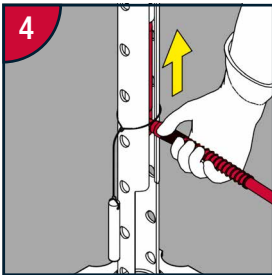

Lift hose to raise ram until ram is as near as possible to inner tube.

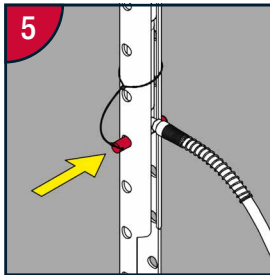

Insert bottom pin through first available hole directly beneath ram.

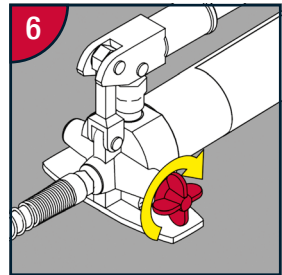

Check flow valve is in closed position (turn clockwise to close).

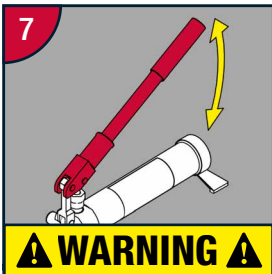

Pump the handle just enough to free the pressure on the top pin. *Do not over-pump.*

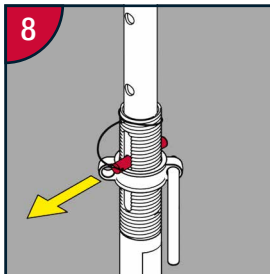

Remove the top pin.

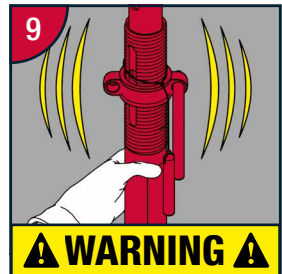

Support outer tube to prevent topple.

UNI-PROP REMOVAL

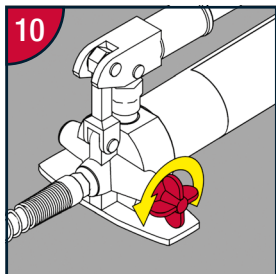

Open flow valve to allow ram stick to retract and inner tube to lower.

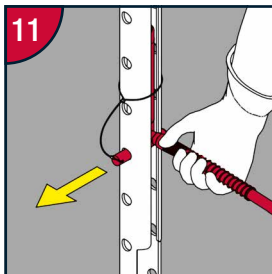

Whilst holding the hose, remove the bottom pin.

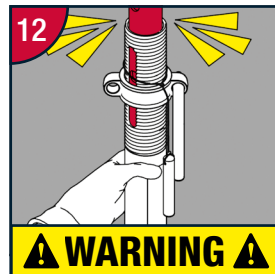

Continue to support outer tube and lower the hose. *Be aware of trap/crush injuries.*

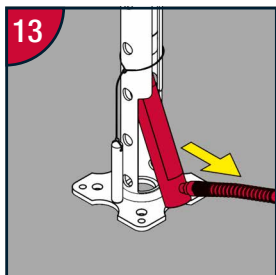

Continue to support outer tube and remove ram via ram access chamber.

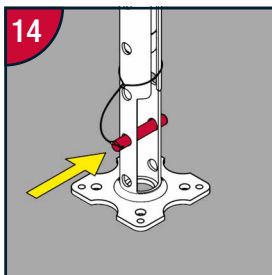

Reinsert bottom pin in its storage position.

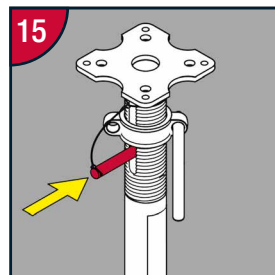

Replace top pin through available hole below collar and the removal is complete.

UNI-PROP MINI

EXTENSIONS & SAFE WORKING LOADS LOADED CONCENTRICALLY AND 1° MAX OUT OF PLUMB

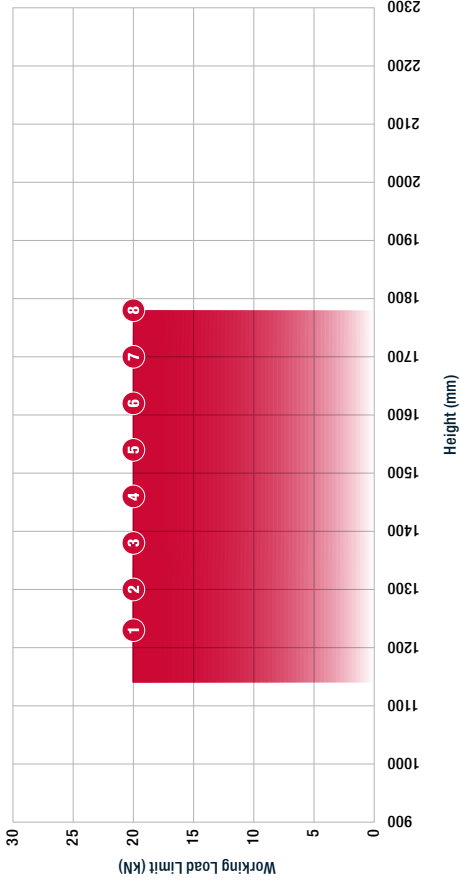

- i) Safe Working Loads are calculated at the maximum available extension per hole in the outer tube.
- ii) Safe Working Loads have been derived from load testing to BS EN 1065.
- iii) Safe Working Loads are calculated to a minimum Factor of Safety of 2.5 to 1 on test results.

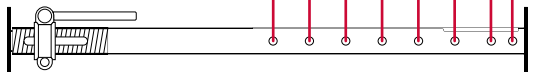

HOLE No.	MIN (mm)	MAX (mm)	MAX (kg)
8	1660	1780	2000
7	1580	1700	2000
6	1500	1620	2000
5	1420	1540	2000
4	1340	1460	2000
3	1260	1380	2000
2	1180	1300	2000
1	1140	1230	2000

UNI-PROP MIDI

EXTENSIONS & SAFE WORKING LOADS LOADED CONCENTRICALLY AND 1° MAX OUT OF PLUMB

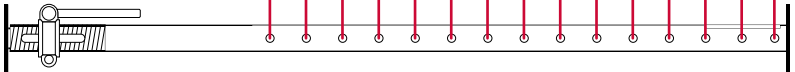

HOLE No.	MIN (mm)	MAX (mm)	MAX (kg)
15	2830	2950	750
14	2750	2870	750
13	2670	2790	1000
12	2590	2710	1250
11	2510	2630	1500
10	2430	2550	1500
9	2350	2470	1500
8	2270	2390	1750
7	2190	2310	2000
6	2110	2230	2000
5	2030	2150	2000
4	1950	2070	2000
3	1870	1990	2000
2	1790	1910	2000
1	1725	1835	2000

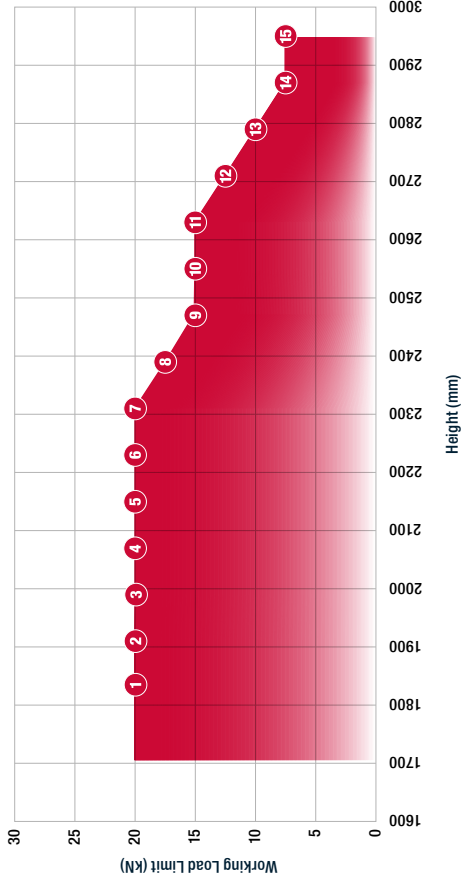

- i) Safe Working Loads are calculated at the maximum available extension per hole in the outer tube.
- For example:
At hole position 8 (2270-2390mm) the maximum Safe Working Load is 17.5kN (1750kg).
- At hole position 9 (2350-2470mm) the maximum Safe Working Load is 15kN (1500kg).
- ii) Safe Working Loads have been derived from load testing to BS EN 1065.
- iii) Safe Working Loads are calculated to a minimum Factor of Safety of 2.5 to 1 on test results.

UNI-PROP MAXI

EXTENSIONS & SAFE WORKING LOADS LOADED CONCENTRICALLY AND 1° MAX OUT OF PLUMB

HOLE No.	MIN (mm)	MAX (mm)	MAX (kg)
15	3210	3330	750
14	3130	3250	750
13	3050	3170	750
12	2970	3090	750
11	2890	3010	1000
10	2810	2930	1250
9	2730	2850	1250
8	2650	2770	1250
7	2570	2690	1500
6	2490	2610	1750
5	2410	2530	1750
4	2330	2450	1750
3	2250	2370	1750
2	2170	2290	2000
1	2105	2215	2000

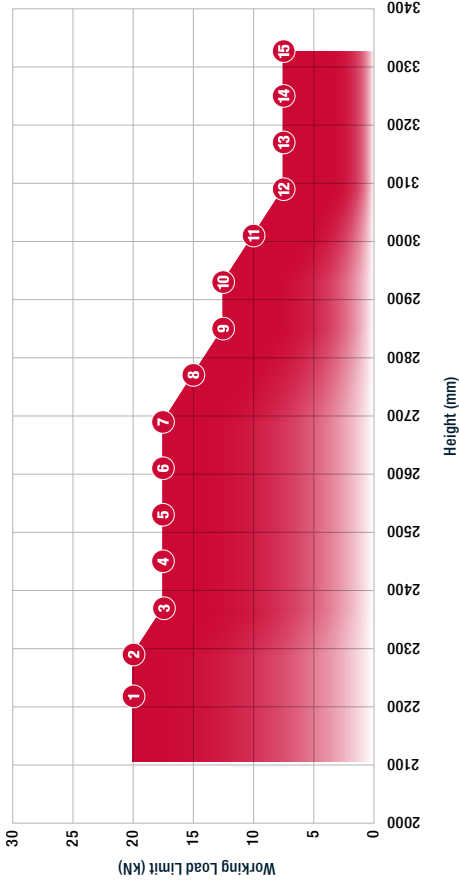

- i) Safe Working Loads are calculated at the maximum available extension per hole in the outer tube.
For example:
At hole position 11 (2890-3010mm) the maximum Safe Working Load is 10kN (1000kg).
At hole position 12 (2970-3090mm) the maximum Safe Working Load is 7.5kN (750kg).
- ii) Safe Working Loads have been derived from load testing to BS EN 1065.
- iii) Safe Working Loads are calculated to a minimum Factor of Safety of 2.5 to 1 on test results.

TROUBLESHOOTING

Ram will not fit inside Ram Access Chamber

- i) Check flow valve is in fully open position (p5 fig.13).
- ii) Check chamber is free of obstruction.

Ram stick will not extend

- i) Check pump is on a horizontal surface (p4 fig.3).
- ii) Check flow valve is in closed position (p4 fig.9).

Ram stick will not retract

- i) Check pump is on a horizontal surface (p4 fig.3).
- ii) Check flow valve is in open position (p5 fig.13).

Ram won't deliver power

- i) The capacity is exceeded.

Cannot locate pin hole in threaded slot

- i) Inner tube hole is not aligned with threaded slot (p4 fig.8).

Hose and Ram will not lower

- i) Make sure bottom pin is removed.

Oil is leaking

- i) A small seepage of oil during early use is perfectly normal.
- ii) If oil continues to leak, do not use the Hydraulic Assembly and contact supplier.

Cannot remove Ram from Ram Access Chamber

- i) Ram stick may not be fully retracted, check flow valve is open (p5 fig.13).
- ii) With the flow valve open, hold hose and tap ram stick up against bottom of inner tube, the ram stick will then fully retract.

IF YOU CONTINUE TO EXPERIENCE OPERATING ISSUES PLEASE CONTACT YOUR SUPPLIER.

ONLINE PDF FILES

ACCESS TO INDIVIDUAL PDFS OF THE QUICK START GUIDE AND USER MANUAL ARE AVAILABLE AT UNI-PROP.COM

PDF

Uni-Prop Temporary Support

- Recommended Working Practices
- Installation
- Removal
- Mechanical Use Only

PDF

Hydraulic Assembly

- Recommended Working Practices
- Equipment Use and Care
- General Maintenance

PDF

Diagrams and Technical Specification

- Hydraulic Assembly Diagram
- Hydraulic Assembly Technical Specification
- Uni-Prop Diagram
- Uni-Prop Technical Specification

PDF

Safe Working Loads

- UP-Mini-0-D1
- UP-Midi-1-D1
- UP-Maxi-2-D1

PDF

Troubleshooting

No part of this document or any drawings contained herein may be reproduced in any shape or form without the written consent of Uni-Prop International Ltd.

© 2018 Uni-Prop® International Ltd.